

Isostatically pressed crucibles

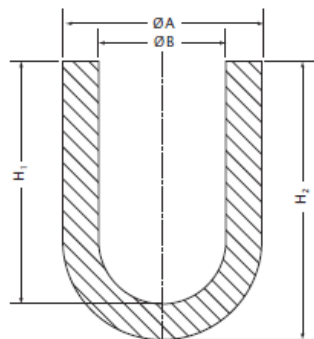

Order #	Dimensions mm				Volume ccm
	ø A	ø B	H ₁	H ₂	
ISO 1	93	79	185	197	900
ISO 2	86	75	209	218	920
ISO 3	116	98	195	210	1450
*ISO 3 F	115	93	184	195	1240
ISO 4	60	50	120	128	230
ISO 5	65	53	190	200	410
ISO 6	147	124	237	250	2850
*ISO 6 F	147	124	237	250	2850
ISO 7	131	111	252	266	2420
ISO 8	42	32	115	120	90
ISO 9	88	68	130	150	470
ISO 10	85	45	130	150	200

* with flat bottom

Rammed cylindrical crucibles

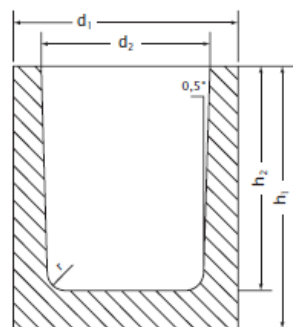

Order #	Dimensions mm				
	d ₁	d ₂	h ₁	h ₂	r
ZT 1	12	8	25	19	1
ZT 2	20	12	25	20	1
ZT 3	13	8	47	42	1
ZT 4	24	18	28	18	1
ZT 5	35	24	97	92	2
ZT 6	43	36	54	48	2
ZT 7	50	39	69	65	2
ZT 8	53	42	80	75	2
ZT 9	57	46	99	89	2
ZT 10	65	54	99	93	3
ZT 11	119	75	170	150	3
ZT 12	127	106	139	127	4
ZT 13*	120	100	22	180	10
ZT 14	215	175	295	255	4
ZT 15	150	127	155	135	5
ZT 16	170	140	185	165	5

* conical outer shape

Customized products according to customer drawings available upon request.

